

INSTALLATION AND MAINTENANCE SHEET

Lubricator Model L31/L32 with Variations and Accessories

WARNING
DO NOT PLACE PLASTIC BOWL UNIT IN SERVICE WITHOUT METAL BOWL GUARD INSTALLED.

Plastic bowl units are sold only with metal bowl guards. To minimize the danger of flying fragments in the event of plastic bowl failure, the metal bowl guards should not be removed. If the unit is in service without the metal bowl guard installed, manufacturer's warranties are void, and the manufacturer assumes no responsibility of, any resulting loss.

IF UNIT HAS BEEN IN SERVICE AND DOES NOT HAVE A METAL BOWL GUARD, ORDER ONE AND INSTALL BEFORE PLACING BACK IN SERVICE.

CAUTION

Certain compressor oils, chemicals, household cleaners, solvents, paints and fumes will attack plastic bowls and can cause bowl failure. Do not use near these materials. When bowl becomes dirty replace bowl or wipe only with a clean, dry cloth. Reinstall metal bowl guard or buy and install a metal bowl guard. Immediately replace any crazed, cracked, damaged or deteriorated plastic bowl with a metal bowl or a new plastic bowl and a metal bowl guard.

WE CANNOT POSSIBLY LIST ALL HARMFUL SUBSTANCES. SO CHECK WITH A MOBAY CHEMICAL OR GENERAL ELECTRIC OFFICE FOR FURTHER INFORMATION ON POLYCARBONATE PLASTIC.

Except as otherwise specified by the manufacturer, this product is specifically designed for compressed air service, and used with any other fluid (liquid or gas) is a misapplication. For example, use with or injection of certain hazardous liquids or gases in the system (such as alcohol or liquid petroleum gas) could be harmful to the unit or result in a combustible condition or hazardous external leakage. Manufacturers warranties are void in the event of misapplication, and manufacturer assumes no responsibility for any resulting loss. Before using with fluids other than air, or for non-industrial applications, or for life support systems consult manufacturer for written approval.

INSTALLATION

1. Refer to warning above.
2. Install as close as possible to the equipment requiring lubrication.
3. Install the unit with the air flowing through the body in the direction indicated by the arrow.
4. Install the same pipe-size unit as the pipeline in use. Avoid using fittings, couplings, etc., that restrict the airflow or baffle the oil out of the air at the lubricator outlet.
5. The lubricator may be filled under pressure by slowly removing the fill plug and pouring oil into the bowl through the tank. The tank may be taken off after the fill plug is removed. Do not replace the fill plug until the tank is secured in place.
NOTE: As the fill plug is removed, the air pressure in the tank will be released.
6. Use only clean non-detergent oil. SAE 10 or lighter is usually best.
7. The rate of oil delivery can be controlled counterclockwise for more and clockwise for less delivery. This lubricator delivers all of the oil downstream that passes through the sight dome. The oil delivery rate will change automatically to deliver more oil during higher air flows and less oil for air flows lower than that at which the original setting was made.
8. Maximum pressure and temperature ratings for metal tanks are 200 psig (14 bar) and 175°F (79°C).

MAINTENANCE

1. Given clean operating conditions, this unit should be trouble-free. Drain off any contaminants which collect in the bottom of the bowl.
2. IF THE OIL DELIVERY RATE DROPS, shut off the air supply to the lubricator and reduce the pressure in the unit to zero. Remove the adjusting screw and clean the needle and seat in the body. Inspect and clean the passage from the needle seat down into the siphon tube adapter. Remove the Flow-Guide® variable orifice screw and clean air passage with a small wire. Check the bore that the screw fits into for contaminants and clean if necessary. Be sure the passageway from the sight dome cavity downward is open. Remove and clean the valve seat.
3. Drain off any contaminants which collect in the bottom of the tank.

REPAIR KITS AND REPLACEMENT PARTS

Bowl O-Ring Kit, Nitrile (10 per kit) (for L31, L32).....	GRP-95-256
Adjusting Screw O-Ring Kit (for L31, L32)	GRP-95-255
Siphon Tube Assembly Kit (for L32).....	LRP-96-211
Fill Plug Kit (for L31, L32)	LRP-95-253
Flow-Guide®, 1 NPT Models (for L31, L32)	LRP-95-190
Sight Dome Kit (for L31, L32)	LRP-95-249
Sight Gauge Kit (for L31)	LRP-95-771
Sight Gauge Kit (for L32)	LRP-95-716
Tamper Resistant Kit (for L31, L32)	LRP-95-587
Force-Fill Adapter (for L31, L32)	GRP-96-394
O-Ring Repair Kit (for L31, L32)	LRP-95-058
Check Ball and O-Ring Kit	LRP-95-310

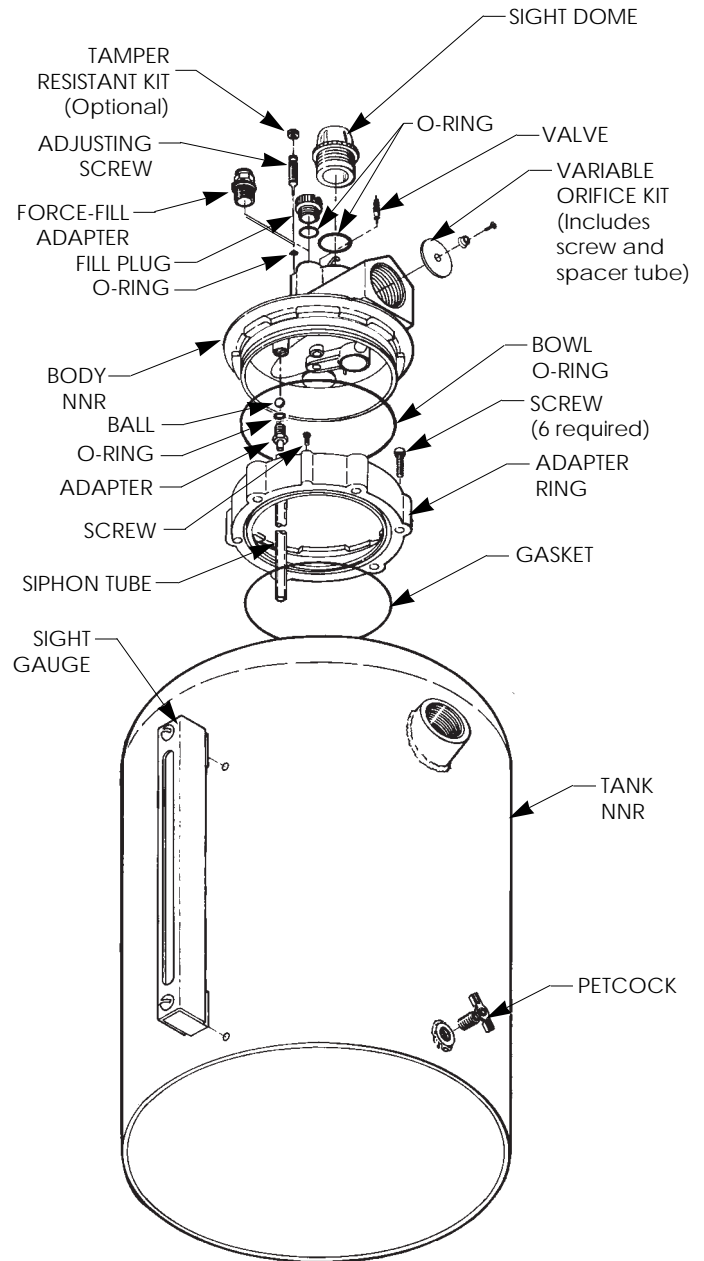

NNR = NOT NORMALLY REPLACED