

WARNING

DO NOT PLACE PLASTIC BOWL UNIT IN SERVICE WITHOUT METAL BOWL GUARD INSTALLED

Plastic bowl units are sold only with metal bowl guards. To minimize the danger of flying fragments in the event of plastic bowl failure, the metal bowl guards should not be removed. If the unit is in service without the metal bowl guard installed, manufacturer's warranties are void, and the manufacturer assumes no responsibility for any resulting loss.

IF UNIT HAS BEEN IN SERVICE AND DOES NOT HAVE A METAL BOWL GUARD, ORDER ONE AND INSTALL BEFORE PLACING BACK IN SERVICE..

For information on materials harmful to plastic bowls, contact a Mobay Chemical or General Electric office for information regarding materials that will attack polycarbonate plastic.

CAUTION

Certain compressor oils, chemicals, household cleaners, solvents, paints and fumes will attack plastic bowls and can cause bowl failure. Do not use near these materials. When bowl becomes dirty replace bowl or wipe only with clean, dry cloth. Reinstall metal bowl guard or buy and install a metal bowl guard. Immediately replace any crazed, cracked, damaged or deteriorated plastic bowl with a metal bowl or a new plastic bowl and metal bowl guard.

EXCEPT as otherwise specified by the manufacturer, this product is specifically designed for compressed air service, and use with any other fluid (liquid or gas) is a misapplication. For example, use with or injection of certain hazardous liquids or gases in the system (such as alcohol or liquid petroleum gas) could be harmful to the unit or result in a combustible condition or hazardous external leakage. Manufacturer's warranties are void in the event of misapplication, and manufacturer assumes no responsibility for any resulting loss. Before using with fluids other than air, or for non-industrial applications, or for life support systems consult manufacturer for written approval.

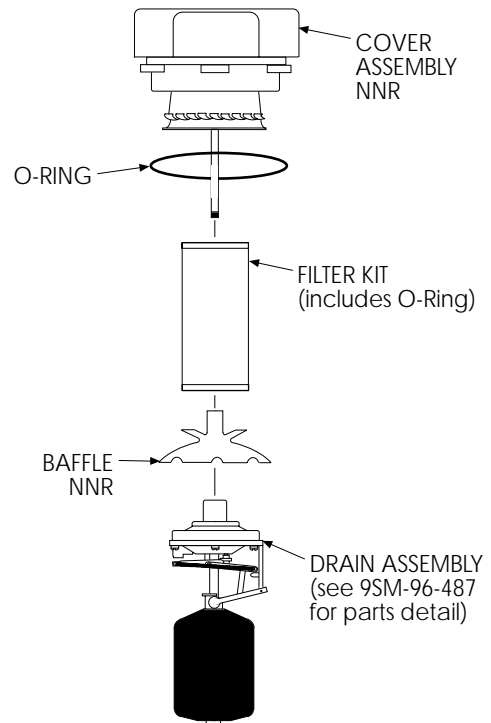

INSTALLATION

1. Refer to the above warning before installing filter.
2. Install as close as possible to the point where air is being used.
3. Install unit with air flowing through the body in the direction indicated by arrow.
4. Install the same size unit as the pipe line in use. Avoid using fittings, couplings, etc. that restrict the airflow.
5. DO NOT install filter where pressure drop could exceed 20 psi. Downstream from a quick-opening valve, for example, could cause a momentary pressure drop in excess of 20 psi.
6. A drain line with 1/8"-inch NPT connect may be attached to drain port if desired. Drain line should be 1/4-inch tubing or larger; as short as possible; and crimp free.
7. Maximum pressure and temperature ratings are: transparent plastic bowls, 150 psig (10,3 bar) and 125°F (52°C); metal bowls, 200 psig (14 bar) and 175°F (79,4°C).
8. Mount unit in vertical position.

MAINTENANCE

1. EACH TIME BOWL IS CLEANED OR THE FILTER ELEMENT REPLACED:
 - a. Depressurize unit.
 - b. Inspect seals and replace crazed, cracked, damaged or deteriorated seals with original manufacturer's approved seals only.
2. FILTER ELEMENT-Clean periodically by removing filter, tapping on hard surface and blowing off with an air blow gun. When cleaning or replacing element, blow off louvers with an air blow gun.
3. Before placing the unit in service be sure that the bowl and bowl guard are reinstalled and the clamp ring is securely locked in position.
4. If automatic bowl drain fails to function properly refer to Service Manual Sheet 9SM-96-487.

REPAIR KITS AND REPLACEMENT PARTS

Repair Kit (Type A Element)	FRP-95-209
Float Drain Assembly	FRP-96-487
Metal Bowl w/Drain Seat	GRP-95-903
Plastic Bowl w/Drain Seat & Bowl Guard	GRP-95-902
Bowl Guard	DRP-95-810

