

INSTALLATION AND MAINTENANCE SHEET

Filter Muffler Model F33 with Variations and Accessories

WARNING

DO NOT PLACE PLASTIC BOWL UNIT IN SERVICE WITHOUT METAL BOWL GUARD INSTALLED

Plastic bowl units are sold only with metal bowl guards. To minimize the danger of flying fragments in the event of plastic bowl failure, the metal bowl guards should not be removed. If the unit is in service without the metal bowl guard installed, manufacturer's warranties are void, and the manufacturer assumes no responsibility for any resulting loss.

IF UNIT HAS BEEN IN SERVICE AND DOES NOT HAVE A METAL BOWL GUARD, ORDER ONE AND INSTALL BEFORE PLACING BACK IN SERVICE.

For information for materials harmful to plastic bowls, contact a Mobay Chemical or General Electric office for information regarding materials that will attack polycarbonate plastic.

CAUTION

Certain compressor oils, chemicals, household cleaners, solvents, paints and fumes will attack plastic bowls and can cause bowl failure. Do not use near these materials. When bowl becomes dirty replace bowl or wipe only with clean, dry cloth. Reinstall metal bowl guard or buy and install a metal bowl guard. Immediately replace any crazed, cracked, damaged or deteriorated plastic bowl with a metal bowl or a new plastic bowl and metal bowl guard.

EXCEPT as otherwise specified by the manufacturer, this product is specifically designed for compressed air service, and use with any other fluid (liquid or gas) is a misapplication. For example, use with or injection of certain hazardous liquids or gases in the system (such as alcohol or liquid petroleum gas) could be harmful to the unit or result in a combustible condition or hazardous external leakage. Manufacturer's warranties are void in the event of misapplication, and manufacturer assumes no responsibility for any resulting loss. Before using with fluids other than air, or for non-industrial applications, consult manufacturer for written approval.

INSTALLATION

1. Refer to the above warning.
2. Install as close as possible to point where air is being used.
3. Install a unit with the same pipe size as the one in use. Avoid using fittings, couplings, etc. that restrict the airflow.
4. Mount unit in a vertical position.
5. Maximum inlet pressure and operating temperature ratings are transparent plastic bowls, 150 psig (10.3 bar) and 125°F (52°C); metal bowls, 200 psig (14 bar) and 175°F (79.4°C).

MAINTENANCE

1. FILTER ELEMENT - Replace or clean periodically by removing filter, tapping on hard surface and blowing off with an air gun. When cleaning or replacing element, blow off louvers with air blow gun.
2. The unit is equipped with a manual petcock; drain the bowl at least once per work shift.
3. Before placing the unit back in service, make sure the bowl and bowl guard are reinstalled and clamp ring is securely locked in place.

REPAIR KITS AND REPLACEMENT PARTS

Repair Kit (Type A Element)	FRP-95-170
Bowl O-Ring Kit	GRP-95-256
Clamp Ring Assembly	GRP-96-404
Bowl Assembly Kit - no guard	GRP-96-181
Plastic Bowl w/manual Drain Seat and Bowl Guard	GRP-95-726
Bowl Guard	GRP-95-808

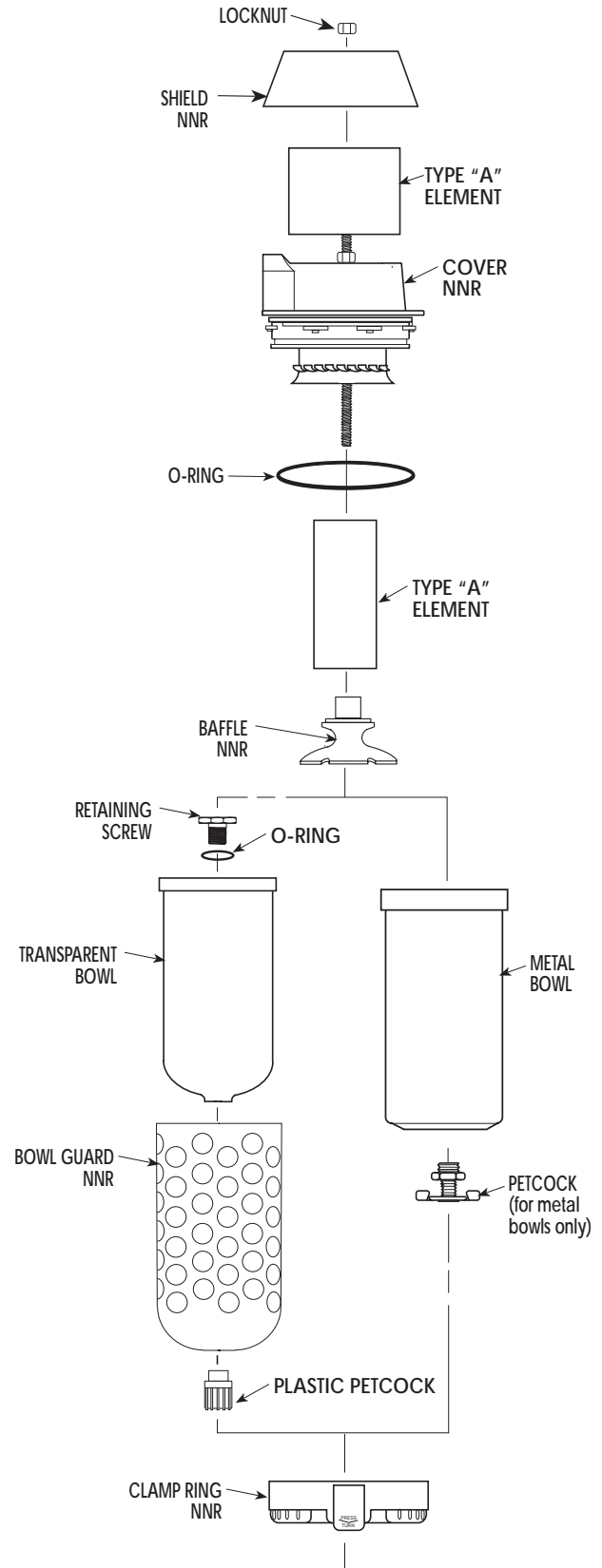

NNR=NOT NORMALLY REPLACED