

### WARNING

Certain compressor oils, chemicals, household cleaners, solvents, paints and fumes will attack plastic bowls and can cause bowl failure. Do not use near these materials. When bowl becomes dirty replace bowl or wipe only with clean, dry cloth. Immediately replace any crazed, cracked, damaged or deteriorated plastic bowl with a new plastic bowl.

### SOME OF THE MATERIALS THAT WILL ATTACK POLYCARBONATE PLASTIC BOWLS.

Acetaldehyde	Chlorobenzene	Methylene chloride
Acetic acid (conc.)	Chloroform	Methylene salicylate
Acetone	Cresol	Milk of lime (CaOH)
Acrylonitrile	Cyclohexanol	Nitric acid (conc.)
Ammonia	Cyclohexanone	Nitrobenzene
Ammonium fluoride	Cyclohexene	Nitrocellulose lacquer
Ammonium hydroxide	Dimethyl formamide	Phenol
Ammonium sulfide	Diozane	Phosphorous hydroxy chloride
Anaerobic adhesives and sealants	Ethane tetrachloride	Phosphorous trichloride
Antifreeze	Ethyl acetate	Propionic acid
Benzene	Ethyl ether	Pyridine
Benzoic acid	Ethylamine	Sodium hydroxide
Benzyl alcohol	Ethylene chlorohydrin	Sodium sulfide
Brake fluids	Ethylene dichloride	Styrene
Bromobenzene	Ethylene glycol	Sulfuric acid (conc.)
Butyric acid	Formic acid (conc.)	Sulphural chloride
Carbolic acid	Freon (refrig. & propell.)	Tetrahydronaphthalene
Carbon disulfide	Gasoline (high aromatic)	Tiophene
Carbon tetrachloride	Hydrazine	Toluene
Caustic potash solution	Hydrochloric acid (conc.)	Turpentine
Caustic soda solution	Lacquer thinner	Xylene
	Methyl alcohol	Perchloroethylene and others

### TRADE NAMES OF SOME COMPRESSOR OILS, RUBBER COMPOUNDS AND OTHER MATERIALS THAT WILL ATTACK POLYCARBONATE PLASTIC BOWLS.

Atlas "Perma-Guard"	National Compound #N11
Buna N	"Nylock" VC-3
Cellulube #150 and #220	Parco #1306 Neoprene
Crylex #5 cement	*Permabond #910
*Eastman 910	Petron PD287
Garlock #98403 (polyurethane)	Prestone
Haskel #568-023	Pydraul AC
Hilgard Co.'s hil phene	Sears Regular Motor Oil
Houghton & Co. oil #1120, #1130 & #1055	Sinclair oil "Lily White"
Houtosafe 1000	Stauffer Chemical FYRQUEL #150
Kano Kroil	Stillman #SR 269-75 (polyurethane)
Keystone penetrating oil #2	Stillman #SR 513-70 (neoprene)
*Loctite 271	Tannergas
*Loctite 290	Telar
*Loctite 601	Tenneco anderol #495 & #500 oils
Loctite Teflon-Sealant	Titon
Marvel Mystery Oil	*Vibra-tite
Minn. Rubber 366Y	Zerex

\*When in raw liquid form.

WE CANNOT POSSIBLY LIST ALL HARMFUL SUBSTANCES, SO CHECK WITH MOBAY CHEMICAL OR THE GENERAL ELECTRIC OFFICE FOR FURTHER INFORMATION ON POLYCARBONATE PLASTIC.

### CAUTION

EXCEPT as otherwise specified by the manufacturer, this product is specifically designed for compressed air service, and use with any other fluid (liquid or gas) is a misapplication. For example, use with or injection of certain hazardous liquids or gases in the system (such as alcohol or liquid petroleum gas) could be harmful to the unit or result in a combustible condition or hazardous external leakage. Manufacturer's warranties are void in the event of misapplication, and manufacturer assumes no responsibility for any resulting loss. Before using with fluids other than air, or for non-industrial applications, or for life support systems consult manufacturer for written approval.

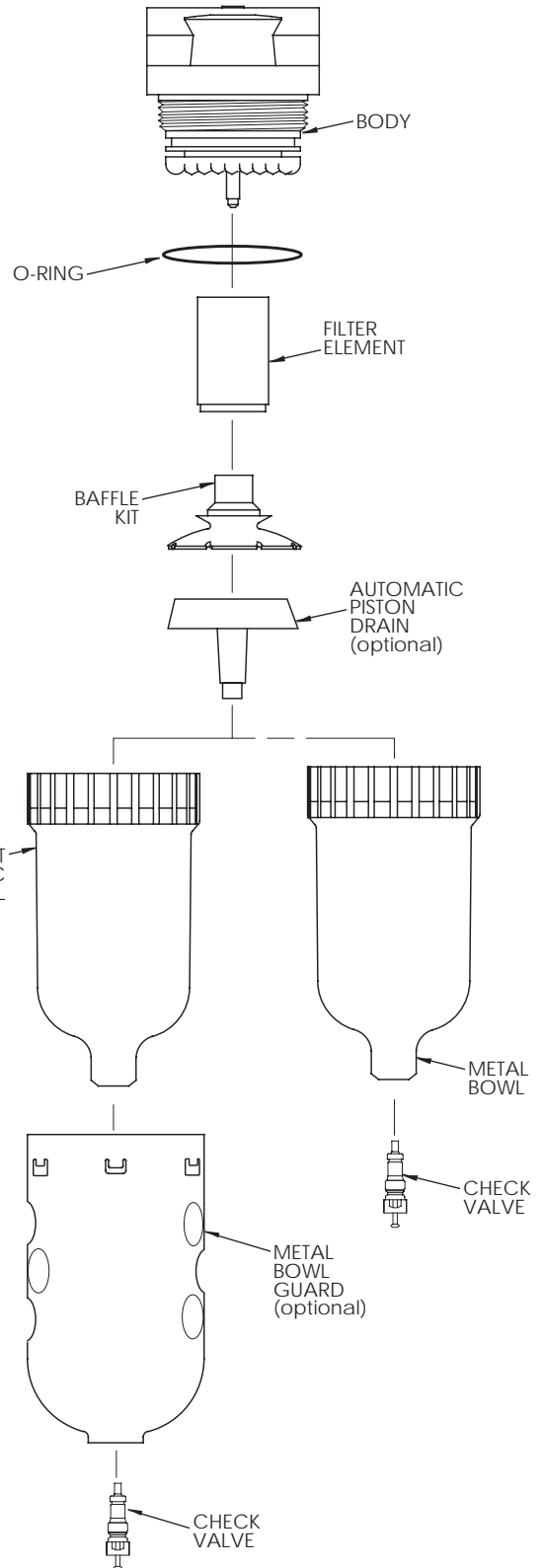

See reverse side for Installation and Maintenance Instructions.

**INSTALLATION**

1. Refer to the warning.
2. Install as close as possible to point where air is being used.
3. Install the unit with the air flowing through the body in the direction indicated by arrow.
4. Install the same pipe-size unit as the pipeline in use. Avoid using fittings, couplings, etc., that restrict air flow.
5. Do not install this unit on any application where the pressure drop will exceed 20 psi. Downstream from a quick-opening valve, for example, could cause a momentary drop in excess of 20 psi (1,4 bar).
6. Maximum inlet pressure and operating temperature ratings are: transparent plastic bowls, 150 psig (10 bar) and 125°F (52°C); metal bowls, 250 psig (17 bar) and 175°F (79°C).

**MAINTENANCE**

1. EACH TIME THE BOWL IS CLEANED OR THE FILTER ELEMENT REPLACED
  - A. Depressurize unit.
  - B. Inspect and replace crazed, cracked, damaged or deteriorated seals and bowls with original manufacturer's approved seals only.
  - C. Inspect bowl and replace crazed, damaged or deteriorated bowl with a new bowl.
2. Remove element and clean periodically by tapping on a hard surface, and blowing off with a blow gun.
3. IF UNIT IS EQUIPPED WITH A MANUAL DRAIN, drain sump whenever water can be seen in bowl by pushing up on the valve stem.
4. Before placing the unit in service, make sure that the bowl and bowl guard are securely locked in place.

**REPAIR KITS AND REPLACEMENT PARTS**

O-Ring Kit .....	<b>GRP-95-264</b>
Filter Element Kit .....	<b>FRP-95-235</b>
Baffle Kit .....	<b>FRP-95-069</b>
Automatic Piston Drain .....	<b>GRP-95-584</b>
Plastic Bowl with check valve .....	<b>GRP-96-310</b>
Plastic Bowl .....	<b>GRP-95-856</b>
Metal Bowl with check valve .....	<b>GRP-96-506</b>
Check Valve (for units w/o automatic piston drain) .....	<b>GRP-96-102</b>
Metal Bowl Guard .....	<b>GRP-96-309</b>

**ACCESSORIES**

Wall Mounting Bracket .....	<b>GRP-95-754</b>
Pipe Mounting Bracket .....	<b>GRP-95-734</b>