

# INSTALLATION AND MAINTENANCE SHEET

## Diaphragm Relief Valve Model X10

### WARNING

**EXCEPT** as otherwise specified by the manufacturer, this product is specifically designed for compressed air service, and use with any other fluid (liquid or gas) is a misapplication. For example, use with or injection of certain hazardous liquids or gases in the system (such as alcohol or liquid petroleum gas) could be harmful to the unit or result in a combustible condition or hazardous external leakage. Manufacturer's warranties are void in the event of misapplication, and manufacturer assumes no responsibility for any resulting loss. Before using with fluids other than air, or for nonindustrial applications, or for life support systems consult manufacturer for written approval.

### INSTALLATION

1. Install as close as possible to where the pressure relieving function is needed.
2. Install the unit with the air flowing through the body in the direction indicated on the body.
3. System piping should be same pipe size as relief valve porting. Avoid using fittings, couplings, etc., that restrict the flow of air.
4. Gauge ports ( $1/8"$ ) are provided in either side of the relief valve body for installation of a gauge or use as an additional outlet port. Plug unused port(s).
5. Panel mount relief valves require a  $1\frac{1}{4}"$  (31,32 mm) diameter hole and are mountable on panels up to  $1/8"$  (3 mm) thick.

### OPERATION

1. Maximum inlet pressure and operating temperature ratings are 125 PSIG (8,5 bar) and 175°F (79°C).
2. Before turning on the supply air pressure, turn the adjusting knob counterclockwise until there is no load on the regulating spring. Turn on the supply air pressure and then turn the adjusting knob clockwise until the desired relief pressure setting is reached. When making a change in pressure setting, always approach the desired pressure from a lower one. When reducing from a higher to a lower setting, first reduce to some pressure less than that desired and then increase to the desired pressure.

### MAINTENANCE

1. The relief valve can be disassembled for servicing without removal from line.
2. **TO DISASSEMBLE**-shut off air to relief valve and vent air line on both sides of relief valve. Turn adjusting screw counterclockwise to relieve compression on spring. Remove knob, bonnet adjusting screw, regulating spring and slip ring. Diaphragm assembly, seat plug and o-ring can now be removed.
3. Occasionally disassemble and clean body and valve seat.
4. **IF UNIT WILL NOT RELIEVE AT REQUIRED PRESSURE**-disassemble, clean and check for wear or damage. Replace worn or damaged parts.

### REPAIR KITS AND REPLACEMENT PARTS

Regulating Springs:	
0-60 psi .....	<b>GRP-95-221</b>
0-125 psi .....	<b>GRP-95-223</b>
Diaphragm Kit .....	<b>RRP-95-298</b>

### ACCESSORIES

Panel Mount Nut .....	<b>RPA-96-734</b>
Wall Mounting Bracket without Panel Nut .....	<b>GRP-95-147</b>
Wall Mounting Bracket 1/8" NPT .....	<b>RRP-95-591</b>
Tamper Resistant Kit .....	<b>RPA-96-735</b>
Gauges:	
0-60 psi .....	<b>GRP-95-228</b>
0-160 psi .....	<b>GRP-95-227</b>

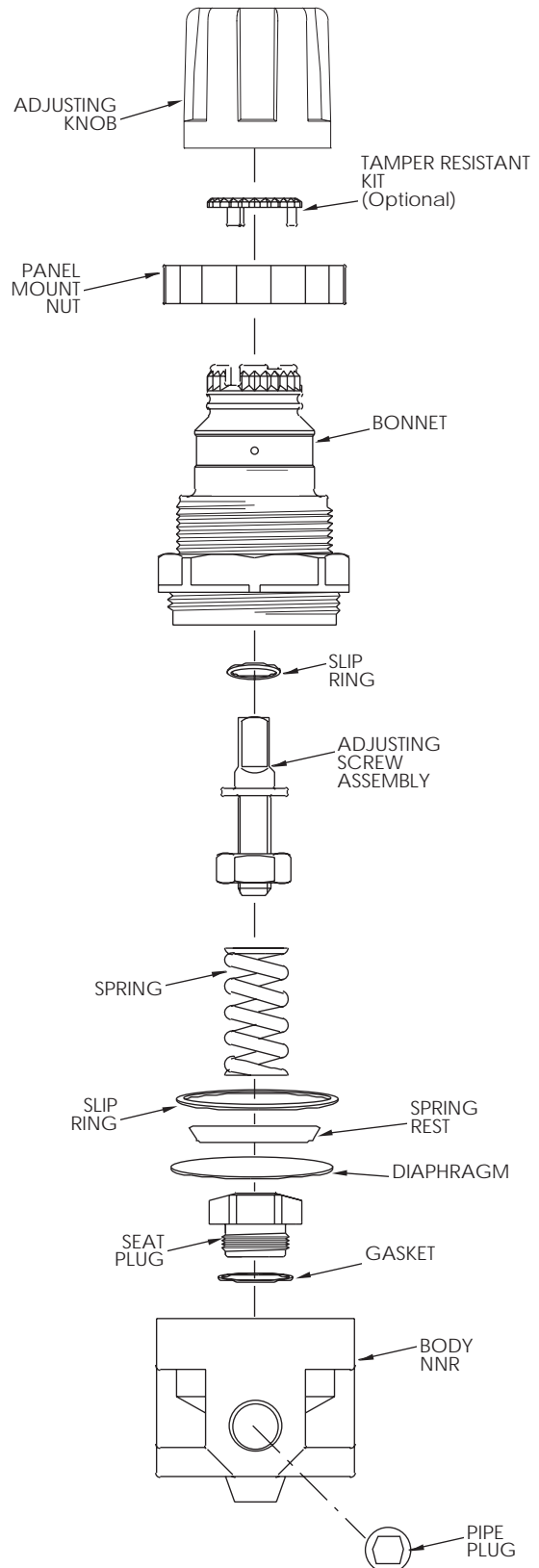

NNR=NOT NORMALLY REPLACED