

WARNING

For information on materials harmful to plastic bowls, contact a Mobay Chemical or General Electric office for information regarding materials that will attack polycarbonate plastic.

CAUTION

Certain compressor oils, chemicals, household cleaners, solvents, paints and fumes will attack plastic bowls and can cause bowl failure. Do not use near these materials. When bowl becomes dirty replace bowl or wipe only with clean, dry cloth. Reinstall bowl or buy and install a new bowl. Immediately replace any crazed, cracked, damaged or deteriorated plastic bowls.

EXCEPT as otherwise specified by the manufacturer, this product is specifically designed for compressed air service, and use with any other fluid (liquid or gas) is a misapplication. For example, use with or injection of certain hazardous liquids or gases in the system (such as alcohol or liquid petroleum gas) could be harmful to the unit or result in a combustible condition or hazardous external leakage. Manufacturer's warranties are void in the event of misapplication, and manufacturer assumes no responsibility for any resulting loss. Before using with fluids other than air, or for nonindustrial applications, or for life support systems consult manufacturer for written approval.

INSTALLATION

1. Refer to above warning.
2. Install as close as possible to the equipment requiring lubrication.
3. Install the unit with the air flowing through the body in the direction indicated by the arrow.
4. Install a unit with the same pipe-size as the pipeline in use. Avoid using fittings, couplings, etc., that restrict airflow.
5. The lubricator cannot be filled under pressure. Turn off air pressure, remove and fill bowl. **DO NOT** turn the air on until the bowl is firmly in position.
6. Use only clean, nondetergent oil, SAE 10, or lighter is usually best.
7. The rate of oil delivery may be controlled by turning the adjusting screw counterclockwise for more and clockwise for less oil delivery. This lubricator delivers all the oil downstream which passes through the sight dome. The oil delivery rate will change automatically to deliver more oil during higher airflows and less oil for airflows lower than that at which the original setting was made.
8. Maximum pressure and operating temperature ratings are: 150 psig (10,3 bar) and 125°F (52°C); metal bowls, 200 psig (14 bar) and 175°F (79,4°C).
9. Install unit in a vertical position.

MAINTENANCE

1. Given clean operating conditions, this unit will be trouble-free. Contaminants from dirty oil may collect on the siphon tube inlet filter, requiring the filter to be cleaned by tapping on a hard surface and blowing off with an air blow gun.
2. IF THE OIL DELIVERY RATE DROPS, the lubricator should be cleaned. Shut off the air supply and reduce the pressure in the unit to zero. Remove the FLOW-GUIDE® orifice screw and clean its air passage with a small wire. Check the bore that the screw fits into for contaminant and clean if necessary. Be sure that the passageway from the sight dome cavity into the FLOW-GUIDE® variable orifice post is open. Remove the adjusting screw and clean the needle and seat in the body. Remove and clean the valve seat and the valve bracket.
3. Drain off any contaminants which collect in the bottom of the bowl.
4. When transparent plastic bowl becomes dirty replace bowl or wipe only with a dry clean cloth. If plastic bowl shows signs of crazing, cracking, damage, or other deterioration immediately replace with a metal bowl or a new plastic bowl and metal bowl guard.

REPAIR KITS AND REPLACEMENT PARTS

Sight Dome Kit with O-Ring	LRP-95-239
Metal Bowl w/Check Valve	GRP-96-506
Plastic Bowl	GRP-95-857
Siphon Tube Assembly	LRP-95-125
Bowl Guard	GRP-96-309
Bowl O-Ring Kit	GRP-95-264

ACCESSORIES

Pipe-Mounting Bracket	GRP-95-734
-----------------------------	------------

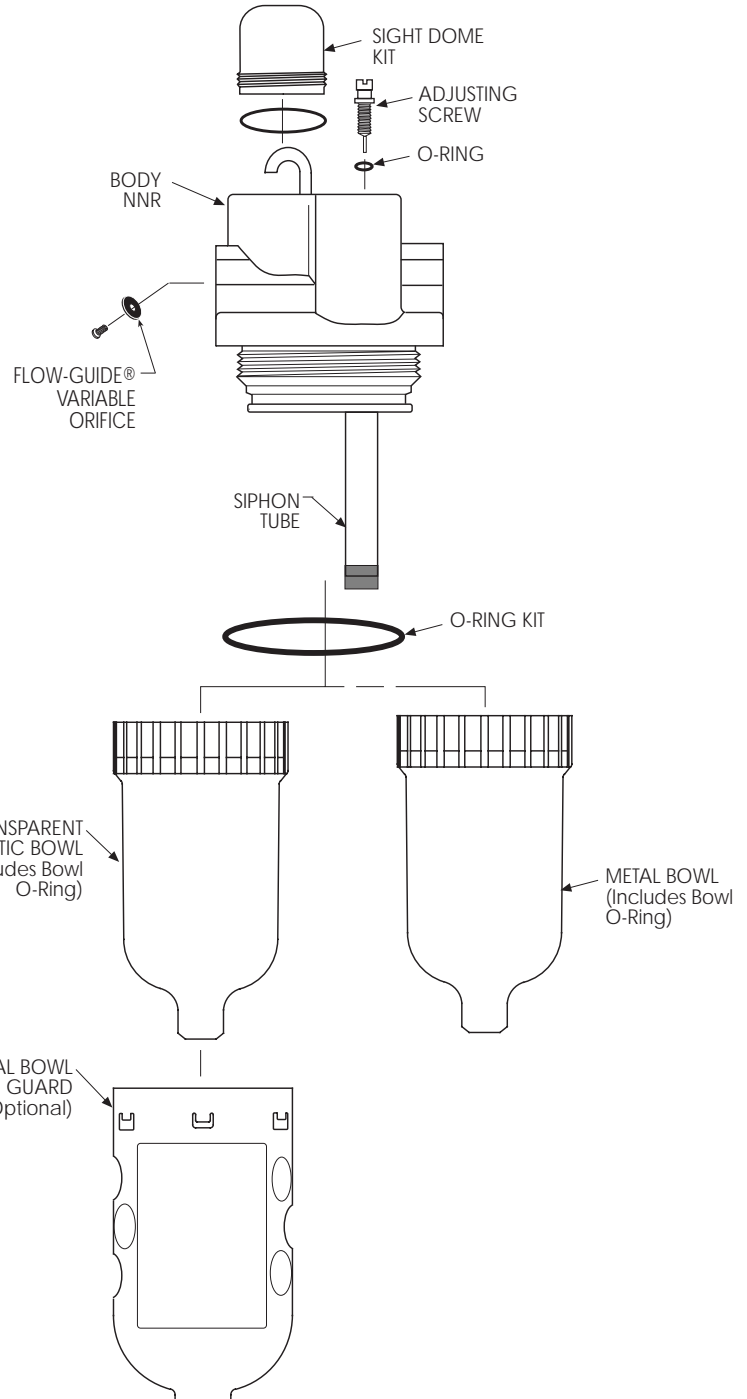

NNR=NOT NORMALLY REPLACED