

Coalescing Filter – Miniature SM1

= "Most Popular"

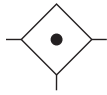

SM1-02-EYV0

Features

- Stainless Steel Construction Handles Most Corrosive Environments
- Meets NACE Specifications MR-01-75/ISO 15156
- 1/8" Female Threaded Drain
- High Flow: 1/4" - 16 SCFM[§]

[§]SCFM = Standard cubic feet per minute at 90 PSIG inlet and 5 PSIG pressure drop.

Specifications

Flow Capacity*	Port Size	0.3 Micron 16 SCFM
Bowl Capacity		1.0 Ounces
Filter Rating		0.3 Micron
Port Threads		1/4 Inch

Pressure & Temperature Ratings –

Metal Bowl –	0 to 300 PSIG (0 to 20.7 bar) 0°F to 180°F (-18°C to 82°C)
Auto Pulse Drain –	10 to 175 PSIG (0.7 to 12 bar) 32°F to 150°F (0°C to 66°C)

Note: Air must be dry enough to avoid ice formation at temperatures below 32°F (0°C).

Useful Retention**	0.4 Ounce
Weight	0.6 lb. (0.27 kg)

* Inlet pressure 90 PSIG (6.2 bar) and 5 PSID (0.3 bar) pressure drop.

**Useful Retention refers to volume below the quiet zone baffle.

Materials of Construction

Body	316 Stainless Steel
Bowl	316 Stainless Steel
Drain (Manual)	316 Stainless Steel
Element Holder	Acetal
Filter Element	Borosilicate Fiber
Seals	Fluorocarbon



Stainless Steel Products

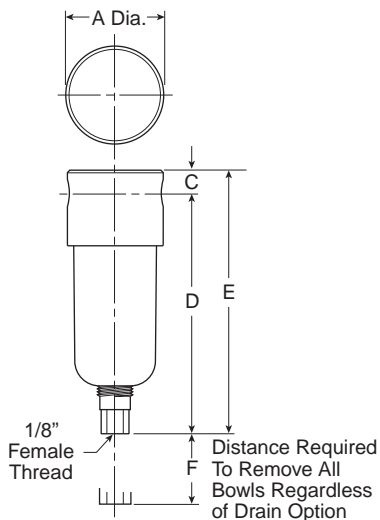

Dimensions

Models	Inches (mm)	A	C	D	E	F
Miniature Unit SM1-02-XXXX		1.57 (40)	0.31 (8)	3.69 (94)	4.00 (102)	1.58 (40)

= "Most Popular"

SM1 Filter Kits & Accessories

- Filter Element Kits – 0.3 Micron..... SRP-96-005
- Manual Drain –
 - Small (Old) SRP-96-008
 - Large (New) SAP05481
- Pipe Nipple – 1/4" 316 Stainless Steel SRP-96-009

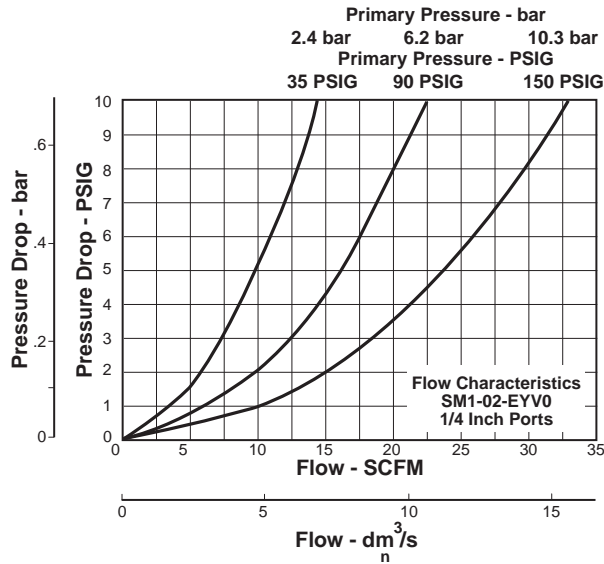

W
Stainless Steel Products

Ordering Information

Model Type	Port Size	Model Number
Manual Drain	1/4	SM1-02-EYV0

Options - To order an option supplied with the unit model, add the appropriate coded suffix letter in the designated position of the model number.